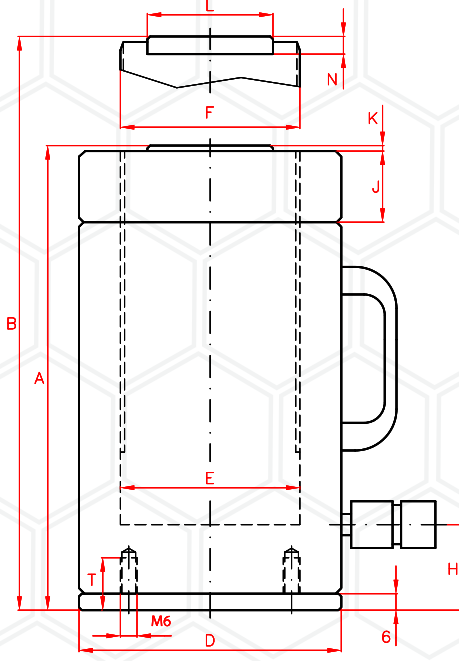

LARZEP
HYDRAULICSAT Serisi Alüminyum Kilit Somunlu Hidrolik Silindirler
SAT Single Acting Load Return Aluminum Lock Nut Cylinders

- 200 Ton** 30 tondan 200 tona kadar hidrolik silindir modelleri
- Maksimum 700 bar çalışma basıncı**
- 50 mm'den 300 mm'ye kadar stroke boyu seçeneği
- Tek etkili, yük geri dönüşlü hidrolik sistem
- Strok aşım valfi ve kırmızı uyarı bandı standart
- Ekstra %50 yük dayanımlı mekanik kilit kapasitesi
- Değiştirilebilir, opsiyonel sertleştirilmiş başlıklar
- Kaliteli alüminyumdan imal dayanıklı silindir gövdesi

Kapasite Capacity		Model	Strok Stroke	Etki Alanı Effect Area	Yağ Hacmi Oil Cap.	A	B	D	E	F	H	J	K	L	N	T	Ağırlık Weight
Ton	kN	LARZEP	mm	cm ²	cm ³	mm	mm	mm	mm	*	mm	mm	mm	mm	mm	mm	kg
30	303	SAT03005	50	44	221	173	223	105	75	Tr 75x4	24	25	3	45	11	19	4.4
30	303	SAT03010	100	44	442	223	323	105	75	Tr 75x4	24	25	3	45	11	19	5.6
30	303	SAT03015	150	44	663	273	423	105	75	Tr 75x4	24	25	3	45	11	19	6.8
30	303	SAT03020	200	44	884	333	533	105	75	Tr 75x4	24	25	3	45	11	19	8
30	303	SAT03025	250	44	1.104	383	633	105	75	Tr 75x4	24	25	3	45	11	19	9.2
30	303	SAT03030	300	44	1.325	433	733	105	75	Tr 75x4	24	25	3	45	11	19	10.5
50	487	SAT05005	50	71	354	193	243	135	95	Tr 95x4	26	35	3	61	12	19	7.9
50	487	SAT05010	100	71	709	243	343	135	95	Tr 95x4	26	35	3	61	12	19	9.9
50	487	SAT05015	150	71	1.063	293	443	135	95	Tr 95x4	26	35	3	61	12	19	11.9
50	487	SAT05020	200	71	1.418	353	553	135	95	Tr 95x4	26	35	3	61	12	19	13.9
50	487	SAT05025	250	71	1.772	403	653	135	95	Tr 95x4	26	35	3	61	12	19	15.9
50	487	SAT05030	300	71	2.126	453	753	135	95	Tr 95x4	26	35	3	61	12	19	17.9
100	911	SAT10005	50	133	664	216	266	180	130	Tr 130x6	32	42	3	88	14	19	15.6
100	911	SAT10010	100	133	1.327	266	366	180	130	Tr 130x6	32	42	3	88	14	19	19.2
100	911	SAT10015	150	133	1.991	326	476	180	130	Tr 130x6	32	42	3	88	14	19	22.8
100	911	SAT10020	200	133	2.655	376	576	180	130	Tr 130x6	32	42	3	88	14	19	26.4
100	911	SAT10025	250	133	3.318	446	696	180	130	Tr 130x6	32	42	3	88	14	19	29.9
100	911	SAT10030	300	133	3.982	496	796	180	130	Tr 130x6	32	42	3	88	14	19	33.5
140	1.380	SAT14005	50	201	1.005	234	284	225	160	Tr 160x6	43	50	3	88	14	19	26
140	1.380	SAT14010	100	201	2.011	284	384	225	160	Tr 160x6	43	50	3	88	14	19	31.6
140	1.380	SAT14015	150	201	3.016	345	495	225	160	Tr 160x6	43	50	3	88	14	19	37.2
140	1.380	SAT14020	200	201	4.021	395	595	225	160	Tr 160x6	43	50	3	88	14	19	43.1
140	1.380	SAT14025	250	201	5.027	465	715	225	160	Tr 160x6	43	50	3	88	14	19	48.3
140	1.380	SAT14030	300	201	6.032	515	815	225	160	Tr 160x6	43	50	3	88	14	19	53.9
200	1.946	SAT20005	50	284	1.418	249	299	265	190	Tr 190x6	43	60	3	111	15	19	42.9
200	1.946	SAT20010	100	284	2.835	299	399	265	190	Tr 190x6	43	60	3	111	15	19	50.6
200	1.946	SAT20015	150	284	4.253	364	514	265	190	Tr 190x6	43	60	3	111	15	19	58.4
200	1.946	SAT20020	200	284	5.671	414	614	265	190	Tr 190x6	43	60	3	111	15	19	66.1
200	1.946	SAT20025	250	284	7.088	479	729	265	190	Tr 190x6	43	60	3	111	15	19	73.9
200	1.946	SAT20030	300	284	8.506	529	829	265	190	Tr 190x6	43	60	3	111	15	19	81.6