

HYDRAULIC COUPLERS



LARZEP advantages

- Low flow and high flow couplers, from 6 to 40 litres/min.
- 700 and 1.000 bar couplers have 3/8"-18 NPT thread. 1.500 bar couplers have 1/4"-BSP thread.
- Male and Female couplers can be supplied separately.
- Steel dust cup available for AZ3120, AZ3140 and AZ3141 couplers.
- AZ3321, AZ3322, AZ3324, AZ3325, AZ3341, AZ3344 and AZ3345: ball quick couplers to guarantee easy and quick connection.
- AZ3120, AZ3140 and AZ3141: standard high flow couplers.
- AZ3220 and AZ3240: low flow couplers. Only used in Maintenance Sets.
- All standard cylinders are supplied with AZ3140 female coupler.
- All cutters are supplied with AZ3321 male ball coupler.

Carefully read and understand the safety instructions.



Never apply pressure to the coupler when it is disconnected.



Apply 2 rounds of Teflon around all 3/8" NPT threads of the system, in the thread direction, leaving the first thread uncovered to prevent the tape breaking and entering the hydraulic system. Torque: 100 Nm.



HYDRAULIC COUPLERS

AZ3

6 - 40 l/min

700-1.500 bar

ACCESSORIES

HIGH FLOW COUPLERS 700 BAR

AZ3120

AZ3140

AZ3141

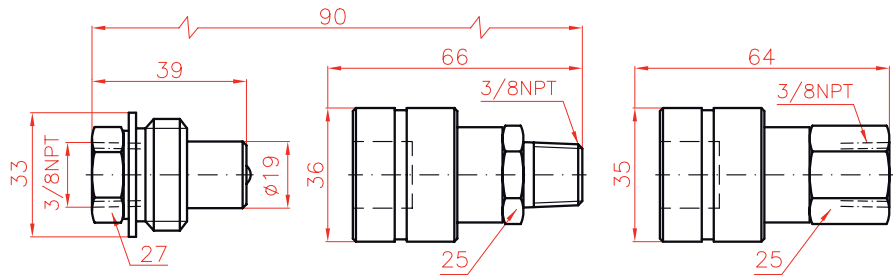

LOW FLOW COUPLERS 700 BAR

AZ3220

AZ3240

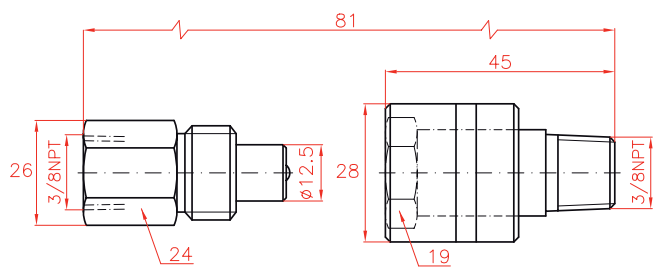

Steel dust cup available:
AZ3144 for female couplers AZ3140
and AZ3141. AZ3124 for male
coupler AZ3120

1.000 BAR BALL COUPLERS

AZ3321

AZ3341

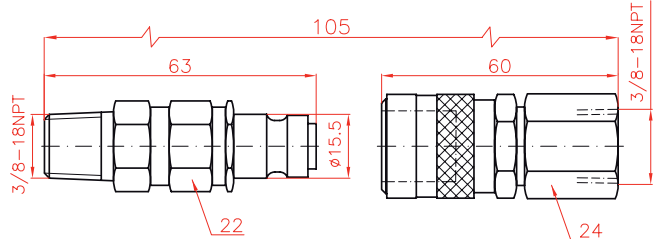

AZ3325

AZ3345

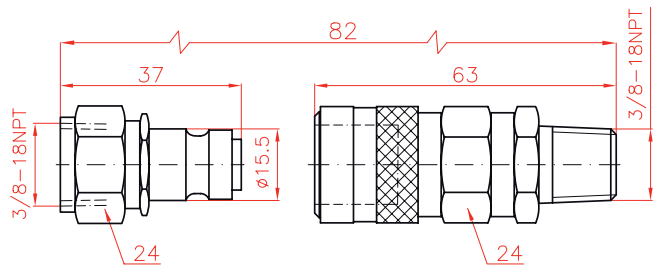

Plastic dust cup AZ3103 available to
suit AZ3120, AZ3140 and AZ3141
couplers.

1.500 BAR BALL COUPLERS

AZ3322

AZ3324

AZ3344

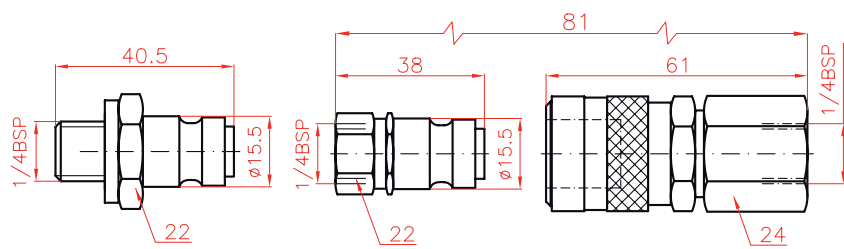

AZ3321, AZ3322, AZ3324
and AZ3325 male couplers are
connectable with AZ3341, AZ3344
and AZ3345 female couplers.

Flow	Coupling	Model	Thread	Pressure
l/min		LARZEP		bar
40	Male	AZ3120	Female 3/8"NPT	700
	Female	AZ3140	Male 3/8"NPT	700
	Female	AZ3141	Female 3/8"NPT	700
7	Male	AZ3220	Female 3/8"NPT	700
	Female	AZ3240	Male 3/8"NPT	700
6	Male	AZ3321	Male 3/8"NPT	1.000
	Male	AZ3325	Female 3/8"NPT	1.000
	Female	AZ3341	Female 3/8"NPT	1.000
	Female	AZ3345	Male 3/8"NPT	1.000
6	Male	AZ3322	Male 1/4"BSP*	1.500
	Male	AZ3324	Female 1/4"BSP*	1.500
	Female	AZ3344	Female 1/4"BSP*	1.500

* Cone 120 °

Ref. AZ3322 without valve.