

## Injectors extractor kit

**Universal**



MADE IN ITALY

Injector removing  
Master kit with  
hidraulic cylinder



*Master* KIT

hydraulic cylinder 12 Ton

hydraulic & mechanical working

- ▶ Complete set for injectors removal
- ▶ **HYDRAULIC CYLINDER:** 12 Ton, 700 bar, 3/8" NPT F connection.
- ▶ **WORKING:** Hydraulic & Mechanical

- ▶ **INJECTORS:** Bosch, Delphi, Siemens, Denso

**THE PUMP TO BE USED WITH THE  
HYDRAULIC CYLINDER IS NOT  
SUPPLIED**

follow us  
on **YouTube**



### Complete Kit

311 166 000

#### Components

Centering

311166003

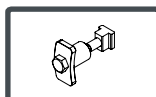

Hydraulic cylinder 12 ton, stroke  
8 mm

311121001



Support plate

311166002

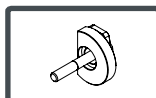

Adjustable levelling foot

311166001

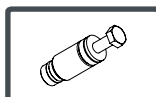

M18x1.5 - l=220 mm screw

311146011

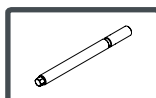

10 mm wrench

311026014

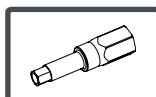

M18x1.5 CH30 nut

311070006

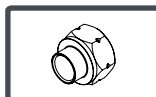

#### Components

Foot extension kit

311166009

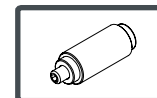

Lower support

311142016

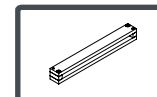

Foot extension

311142007

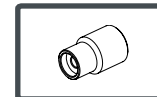

continued »

## Injectors extractor kit



MADE IN ITALY

### Components

Washer

311083004



Bracket

311070030

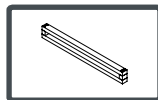

M18x1.5 mm double connection screw - BOSCH

311166005

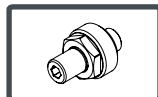

CH24 - M14x1.5 adapter - DELPHI

311146013

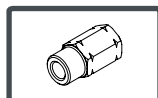

CH24 - M16x1 adapter - TOYOTA

311146014

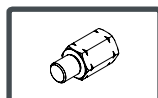

### Components

CH24 - M20x1 adapter - DENSO

311146015

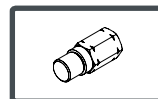

CH24 - M25x1 adapter - SIEMENS

311146016

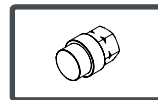

CH24 - M27x1 adapter - SIEMENS

311146017

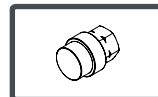

Female extension / female M18x1.5

311166007

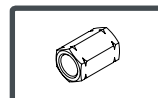

Male extension/female M18x1.5

311166008

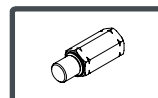

The kit is suitable for the extraction of numerous models of injectors specifically M17x1 for Bosch, M14x1 for Delphi models, Toyota with adapter M16x1, M20x1 used for the extraction of Denso injectors and finally M25x1 and M27x1 for Siemens.

This kit can be used directly on the vehicle, with the engine mounted; its **mechanical operation** in fact, allows it to be used in confined spaces or in the far back position near the passenger compartment.

The **hydraulic application**, reaches its maximum effectiveness in situations in which the injector is strongly seized up.

The advantage of the supporting feet adjustment, on the fixing screws of the head, ensures its use in different levels (right and left); as well as the possibility to adjust the slippage of the two side bars.

The adjustment, therefore, takes place both in height and width according to the conformity of the engine head.

