



EC Serisi 10-20 Ton Hidrolik Masa Presleri

EC Hydraulic Presses 10-20 Ton



- » Masa presi kapasitesi 10 ya da 20 ton
- » Kriko çalışma kursu boyu (strok) 130 mm
- » Çalışma basıncı 700 bar, tek etkili yay dönüşlü kriko
- » El pompalı, hidropnömatik ve elektrikli pompa seçeneği
- » V bloğu, tonaj manometresi sevkiyat içeriğine dahildir
- » Komple kaynaklı şase, sağlam uzun ömürlü dayanıklı yapı
- » Küçük hacimli, ergonomik tasarımı, bakım gerektirmez
- » Yağ sızdırmaz, laboratuvar gibi temiz ortamları için ideal

- » Extremely sturdy frames, made from welded steel profiles, available as bench mount (EC series) and floor mounted H-Frame models.
- » Models are available powered by hand pump, air/hydraulic pump or electric/hydraulic pump.
- » CE versions are fitted with remote motor control.
- » Vee blocks and a pressure gauge reading in tons are supplied as standard.
- » The hydraulic cylinder on the ECM and ECZ bench presses can be easily be removed and used in other applications.

10 Ton Hidrolik Masa Presleri / 10 Ton Hydraulic Table Presses

Model	Güç Kaynağı	Kapasite Capacity	Strok Stroke	E	H	A	B	C	F	Ağırlık Weight
Larzep	Power Source	Ton	mm	mm	mm	mm	mm	mm	mm	kg
ECM01113	El Pompalı Hand Pump	10	130	350	352	720	440	220	170	41
ECZ01113	Hidropnömatik Pompa Air Hydraulic Pump	10	130	350	352	720	440	220	170	42
ECE01113	Elektrikli Ünite Electric Pump	10	130	350	352	720	400	220	170	75

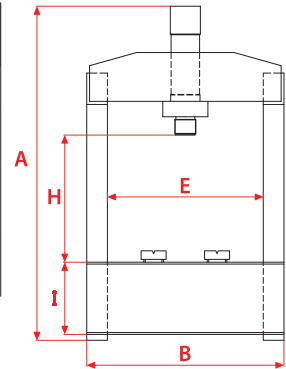

20 Ton Hidrolik Masa Presleri / 20 Ton Hydraulic Table Presses

Model	Güç Kaynağı	Kapasite Capacity	Strok Stroke	E	H	A	B	C	F	Ağırlık Weight
Larzep	Power Source	Ton	mm	mm	mm	mm	mm	mm	mm	kg
ECM02013	El Pompalı Hand Pump	20	130	500	330	785	610	325	240	85
ECZ02013	Hidropnömatik Pompa Air Hydraulic Pump	20	130	500	330	785	610	325	240	90
ECE02013	Elektrikli Ünite Electric Pump	20	130	500	330	785	610	325	240	150

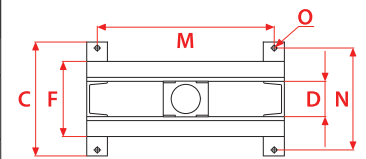

Piston İlerleme Hızları / Advance Speed

Model	10 ton	20 ton
El Pompalı pres piston ilerleme hızı (Her basışta) Hand Pump (mm/stroke)	1.7 mm	0.9 mm
Hidropnömatik pompalı pres piston ilerleme hızı Air Pump (mm/sec.)	1.8 mm/san	1.2 mm/san
Elektrikli güç ünitesi pres piston ilerleme hızı Electric Pump (mm/sec.)	5.8 mm/san	3.9 mm/san

