

2840D WATER JETTING



Water jetting applications

#											
	DN	size	mm	inch	mm	bar	psi	bar	psi	mm	kg/m
2840D-03V34	5	-03	4.5	3/16	15.0	4000	58,000	8000	116,000	200.0	0.66
2840D-05V36	8	-05	7.7	5/16	19.5	3000	43,500	7000	101,500	250.0	1.10
2840D-08V30	12	-08	12.7	1/2	29.8	2500	36,250	6250	90,625	350.0	2.50

APPLICATIONS

For very-high pressure lances for the construction and shipbuilding industries or for common industrial cleaning applications. Mainly used for hydrodemolition and removal of accumulated dirt and materials from surfaces such as concrete, asphalt and tanks.

FEATURES

- Meets or exceeds the requirements of DIN EN 1829-2. This standard prescribes that hose assemblies have to resist at least 20,000 impulses cycles amongst other challenges
- Available with quick connect Polyflex Lok System

CONSTRUCTION

Core tube: Polyoxymethylene.
Pressure reinforcement: Eight spiral layers of maximum tensile steel wire.
Cover: Polyamide.
Colour: DN5: red, DN8: red, DN12: black.

TEMPERATURE RANGE

-10°C up to +70°C.

FITTINGS

Type "M" female swivel: Nipple: very high strength stainless steel.
 Shell and nut: high strength carbon steel, zinc plated.

#						A	B			
	DN	size	mm	inch					mm	mm
1AY2X-6-03	5	-03	4.8	3/16	9/16 - 18 UNF	91.0	38.0	22.0	4000	58,000
1AY2X-8-05	8	-05	7.9	5/16	3/4 - 16 UNF	91.0	38.0	27.0	3200	46,400
1AY2X-10-05	8	-05	7.9	5/16	7/8 - 14 UNF	91.0	38.0	30.0	3200	46,400
1AY2X-13-05	8	-05	7.9	5/16	1 1/8 - 11 UNF	91.0	38.0	36.0	3200	46,400

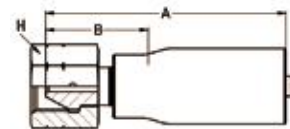

High pressure tube nipple UNF – LH thread: Nipple: very high strength stainless steel.
 Shell: high strength carbon steel, zinc plated.

#						A	B		
	DN	size	mm	inch				mm	mm
1Y42X-4-03	5	-03	4.8	3/16	1/4 - 28 UNF-LH	116.0	63.0	4000	58,000
1Y42X-6-03	5	-03	4.8	3/16	3/8 - 24 UNF-LH	108.0	58.0	4000	58,000
1Y42X-9-03	5	-03	4.8	3/16	9/16 - 18 UNF-LH	116.0	63.0	4000	58,000
1Y42X-6-05	8	-05	7.9	5/16	3/8 - 24 UNF-LH	116.0	63.0	4000	58,000
1Y42X-9-05	8	-05	7.9	5/16	9/16 - 18 UNF-LH	116.0	63.0	4000	58,000
6Y4WX-16-8C	12	-08	12.7	1/2	1 - 14 UNF-LH	147.0	77.0	3000	43,500

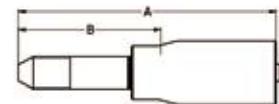



Please Note: Variety of fittings in mild steel or stainless steel available, other fittings available on request.
 We reserve the right to make technical changes without notice.



2840D WATER JETTING

High pressure tube nipple metric – LH thread: Nipple: very high strength stainless steel.
Shell: high strength carbon steel, zinc plated.

#						A	B		
	DN	size	mm	inch				mm	mm
1YM2X-6-03	5	-03	4.8	3/16	M14 x 1.5-LH	116.0	63.0	4000	58,000
1YM2X-6-05	8	-05	7.9	5/16	M14 x 1.5-LH	116.0	63.0	4000	58,000
6YMWX-11-8C	12	-08	12.8	1/2	M18 x 1.5-LH	189.0	125.0	2500	36,250
6YMWX-12-8C	12	-08	12.8	1/2	M20 x 1.5-LH	190.0	125.0	3000	43,500

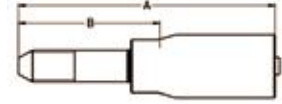

Polyflex Lok components

#	Description
1TM2X-8-03-HPK	Fitting for DN5 hoses incl. caps (refer to page 90)
1TM2X-8-05-HPK	Fitting for DN8 hoses incl. caps (refer to page 90)



For UHP accessories. Refer to page 92.



Please Note: Variety of fittings in mild steel or stainless steel available, other fittings available on request.
We reserve the right to make technical changes without notice.